

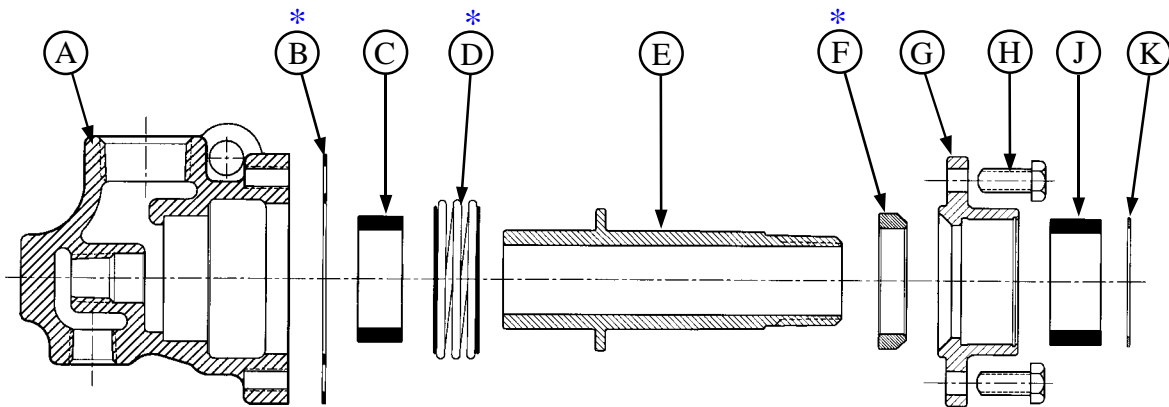

# Type "C" & "G"

## Rotary Joint Repair Kits & Repair Procedure

Issued 09/08



### Rebuilding Kit Components

Cast Iron Casing	A	Spherical Carbon Seal	* F
Grafoil Gasket	* B	Ferrous / Bronze End Cap	G
Carbon Bearing	C	Cap Screw	H
Stn. Stl. Spring & Spring Guides	* D	Carbon Bearing	J
Ferrous / Bronze Sleeve	E	Stn. Stl. Retaining Ring	K

### Repair Procedure

Please refer to illustration above.

1. Remove joint from equipment.
2. Remove cap screws—Part H.
3. Remove Sleeve (E), End Cap (G), Spherical Carbon Seal (F) and Spring and Spring Guides (D) from casing (A).
4. Inspection and Parts Replacement Procedure.

Part G—End Cap should be inspected for wear and roughness.

Part F—Spherical Carbon Seal—If carbon seal is worn to the extent that it allows sleeve to come through end cap per maximum of dimension "X" or if seal surfaces appear rough or chipped, replace.

Part E—Inspect Sleeve to be sure sealing face of shoulder is smooth and clean. Also, bearing areas must be smooth and not pitted. (If it cannot be cleaned up smooth with light buffing, replace).

Part D—Spring and Spring Guides should be replaced when seal is replaced.

Parts C & J—Carbon Bearings—If bearings in casing and end cap are worn with resulting sloppy fit on the sleeve, they should be replaced. These bearings may be purchased as part of either the end cap or casing assemblies.

\* Items in repair kits.

5. Be sure all the sealing and mating surfaces are clean of all foreign particles.
6. Reassembly using a new gasket—Part B. Draw up cap screws evenly so that sleeve does not become "cocked" in casing.
7. Rotate Sleeve a few turns to lap sealing surfaces together.
8. In all cases—joint must be installed with flexible connection to allow it to float freely. Tie rods (if used for holding joints) must not restrict "free floating" action.

### Type "G" Rebuilding Kit

Type	Joint Size	Part Number	"X" dim.
"G"	1-1/4"	10-64571-00	.34"
	1-1/2"	10-64572-00	.34"
	2"	10-64573-00	.41"

### Type "C" Rebuilding Kit

Type	Joint Size	Part Number	"X" dim.
"C"	1/2"	10-27274-00	.19"
	3/4"	10-27275-00	.19"
	1"	10-27276-00	.25"
	1-1/4"	10-27277-00	.25"
	1-1/2"	10-27278-00	.25"
	2"	10-27279-00	.31"
	2-1/2"	10-27280-00	.25"
3"	10-27281-00	.25"	